

HWAA SHOW #5

March 23rd, 2024



Site Coordinator:

Marques Eckhoff

Email: marques.eckhoff@bpsne.net

Office: 402.293.4070

Cell: 217.827.9889

Site Address:

Bellevue West

1501 Thurston Ave, Bellevue, NE 68123

Please see the maps at the end of the packet to help clarify the information provided below.

Directions

Bellevue West High School is located north east of Hwy 75 and Cornhusker Rd.

Parking

Bus and van parking will be in the lot north west of the school. Spectator parking is in the lot east of the school.

Unit Check-In

Our volunteers will greet you at the Check-In table at the Performer's Entrance to walk your designated instructor/assistant through the school. We will show them the general flow and warm-up areas if desired.

At the check-in table, passes for participants and 7 staff/volunteers passes will be provided. If you have late arriving staff members, they will need to obtain passes from the individual who picked up the packet.

Additional staff passes will not be handed out at check-in table.

If you have more than 7 staff/volunteers, admission will need to be purchased to enter the performance gym, even if they are assisting you with the performance.

Equipment Drop Off

Tarp, prop, and guard and percussion equipment drop off will be on the south side of the building. All equipment, other than tarps and props, is to be stored in the homeroom area (guard) and assigned storage area (percussion).

Homerooms

All belongings may be stored at your "homerooms" (designated areas either in the commons or cafeteria labeled by signs). Every area, except warm-up is a "No Spinning" Zone. Playing on pads may be done in "homerooms" but please do not play in the hallways or non-warm-up areas.

Warm-up Area

Units have been assigned a Warm-up Area. Groups may use the time as they see fit. Percussion and Winds units are NOT permitted to march in warm-up areas. Warm-up area supervisors will alert units when there are five minutes and one minute remaining.

Units must leave on time to allow for transit to the on-deck area, as well as to allow the unit after to use the full amount of warm-up time.

Performance Area

We will use a HORIZONTAL timeline. Performers will enter from the double doors on the southwest side of the gym and exit the northwest side. If time permits, units will be allowed to re-fold tarps in the gym or warm-up areas during breaks in the show. Please check with an HWAA board member or the T&P judge for approval.

Music checks for guard must be done prior to the start of the show or during breaks. You must bring your music to the announcer table located in the gym.

Power will be supplied in the front and back of the gym for all units.

Spectator Entrance

There is one spectator entrance located on the east side of the building.

As set by HWAA Contest Rules, Admission prices are \$15 for adults and \$10 for students/seniors (65+).

Children under 5 years old are free. Credit cards will be accepted at the gate.

All spectators must receive a stamp/wristband to gain entrance to the performance area.

Concessions

Concessions will be available during the event near the spectator entrances to the gym.

Shout Outs

Show your support for your group/member/loved ones! Wish them good luck! Purchase a "SHOUT OUT" which will be announced while your group is setting up for their performance. "SHOUT OUTS" will cost \$1.00.

Additional Information

In accordance with HWAA Membership and Contest Rules, Section VII.F

1. Photography of any kind is not allowed at all HWAA events, excluding photographers contracted by the Circuit.
2. There shall be no public recording of any kind at all HWAA events.

Bellevue West High School
1501 Thurston Ave, Bellevue, NE 68123

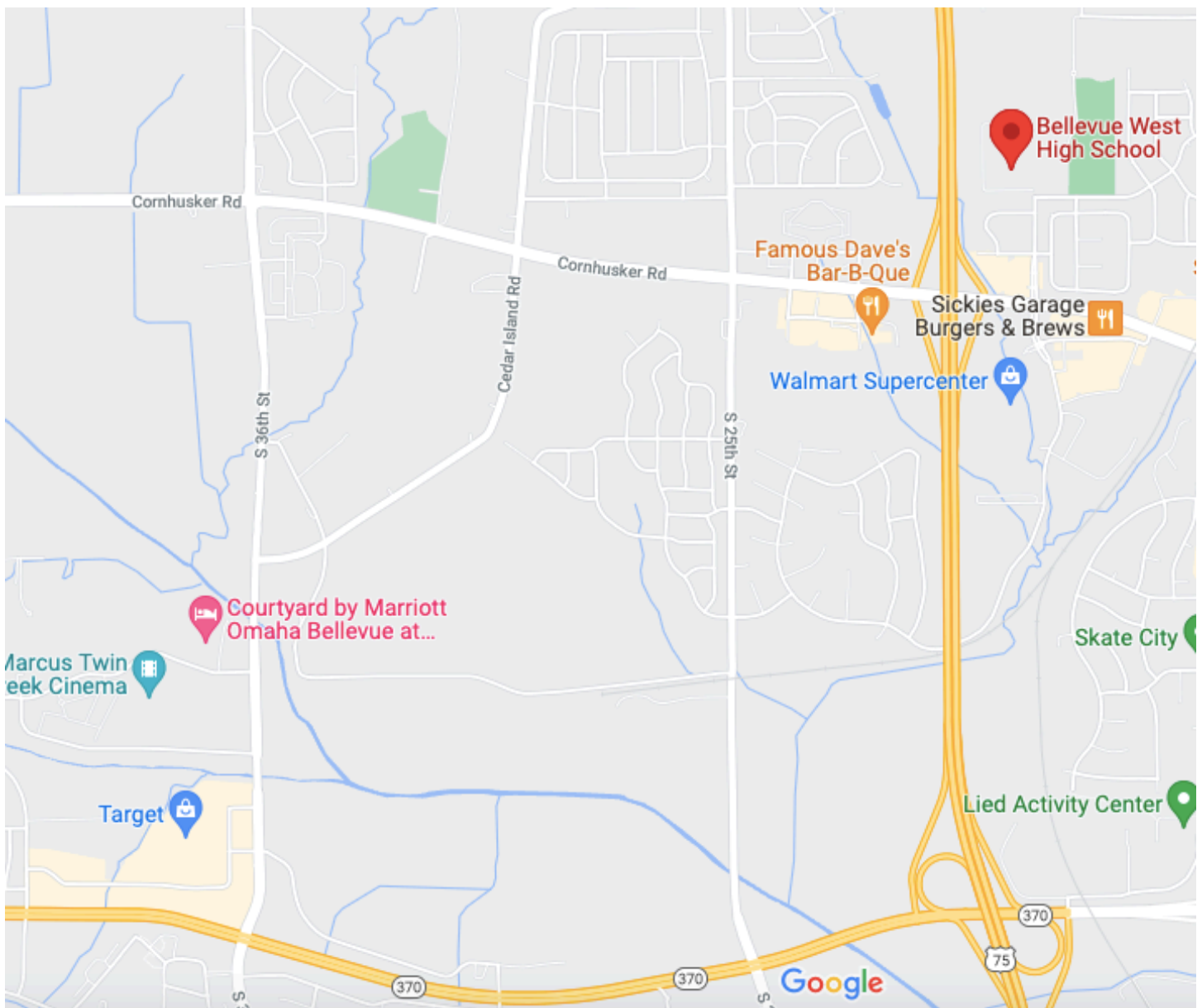

Map

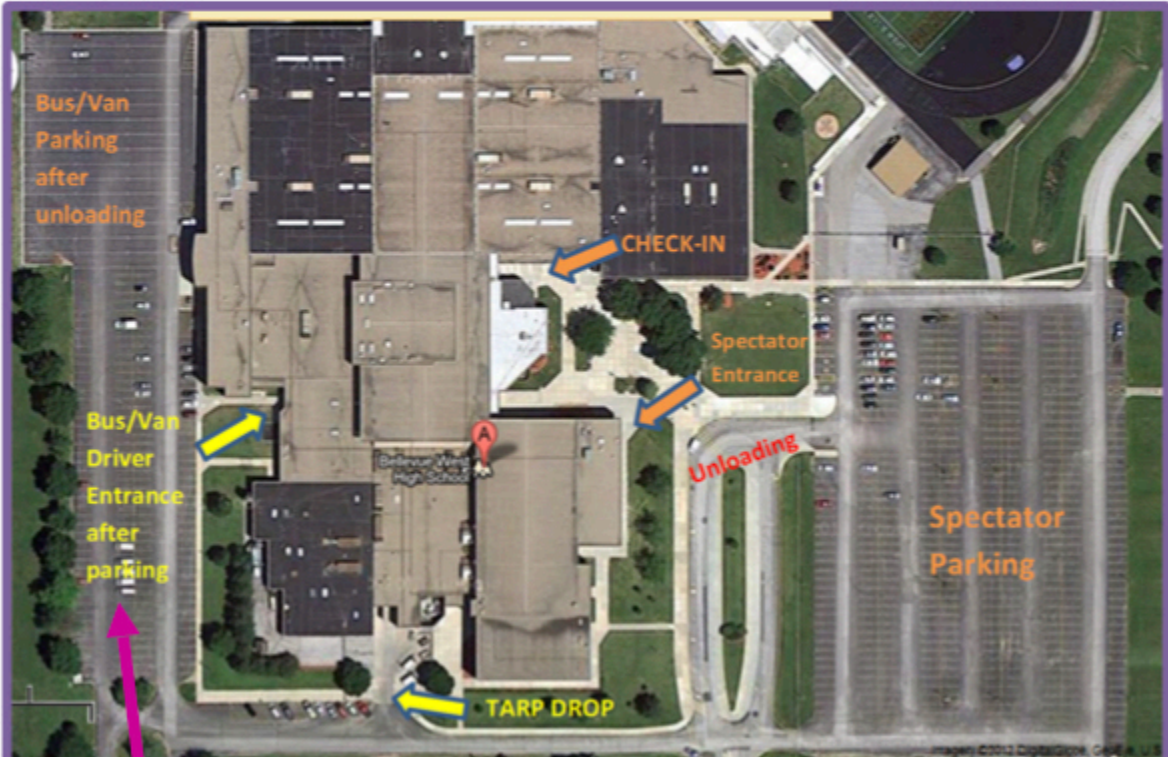

Traffic Flow

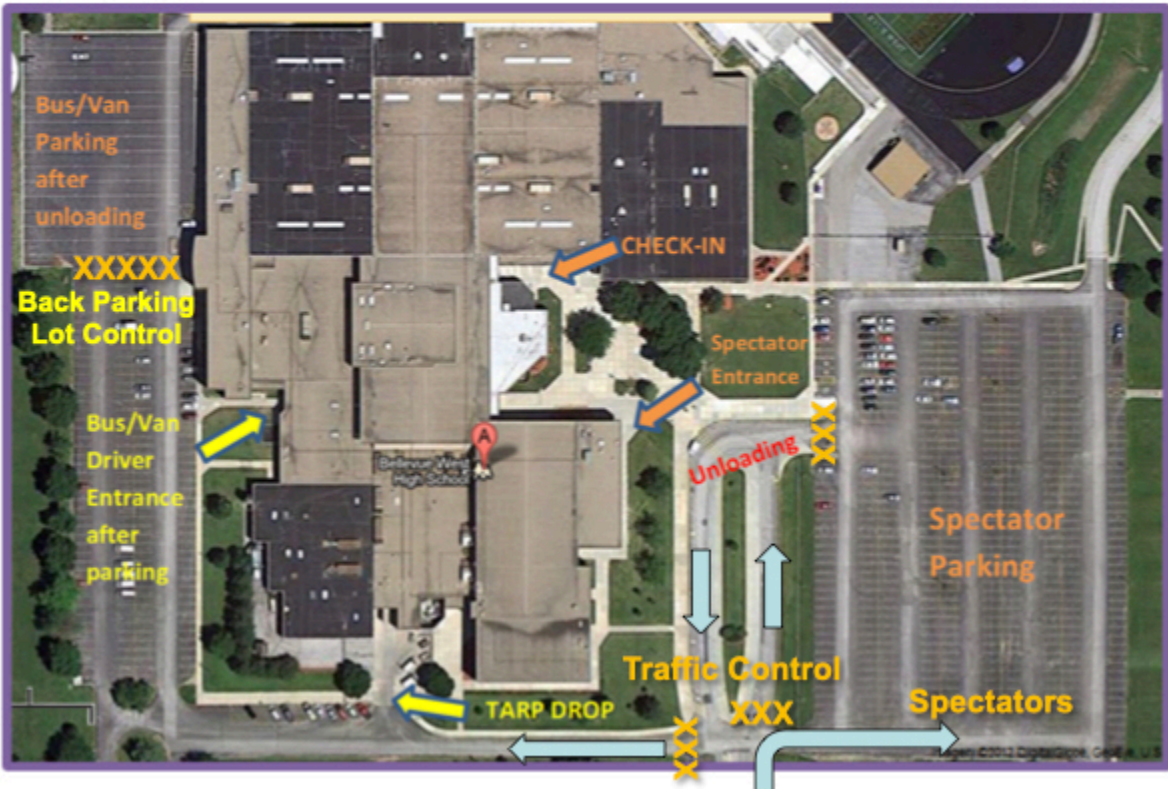

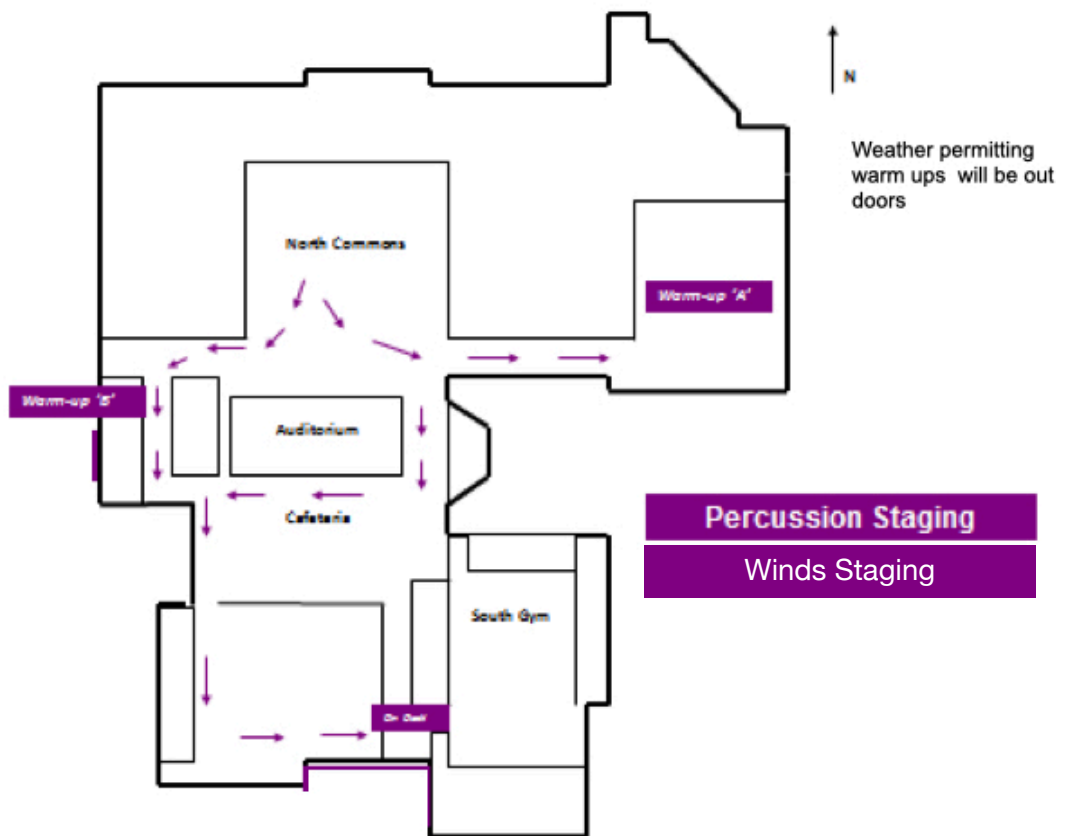
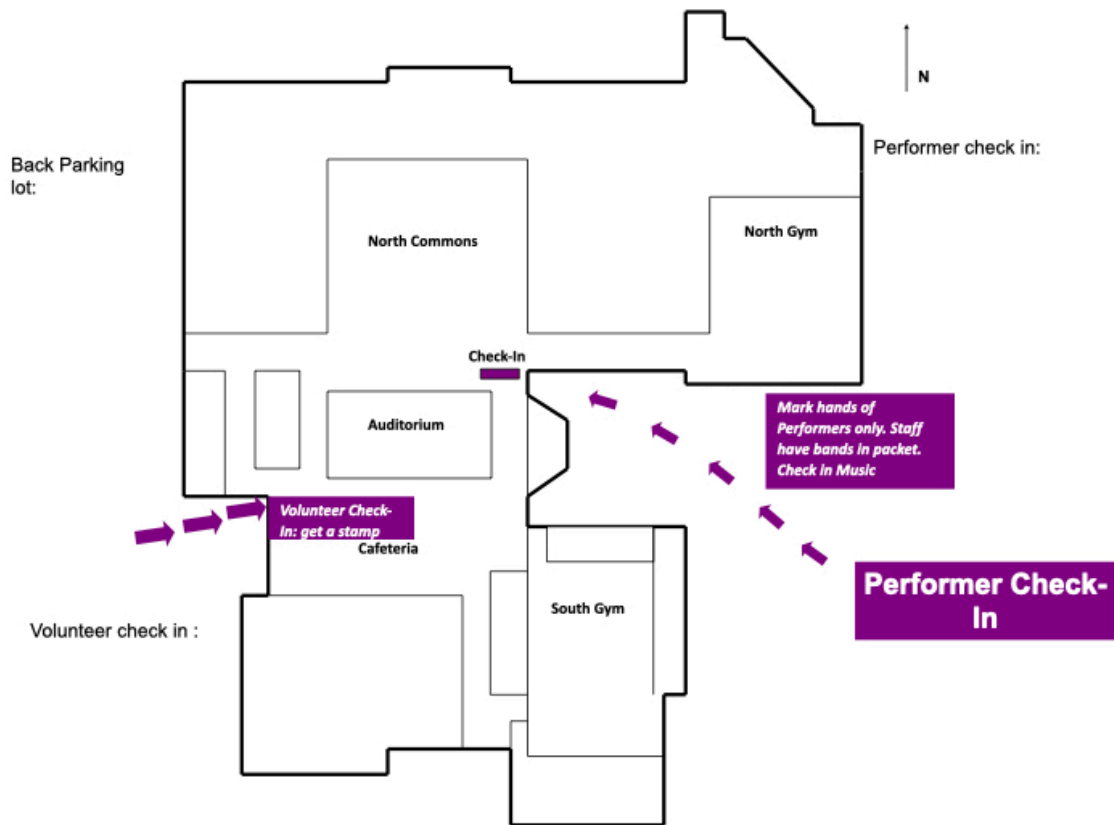

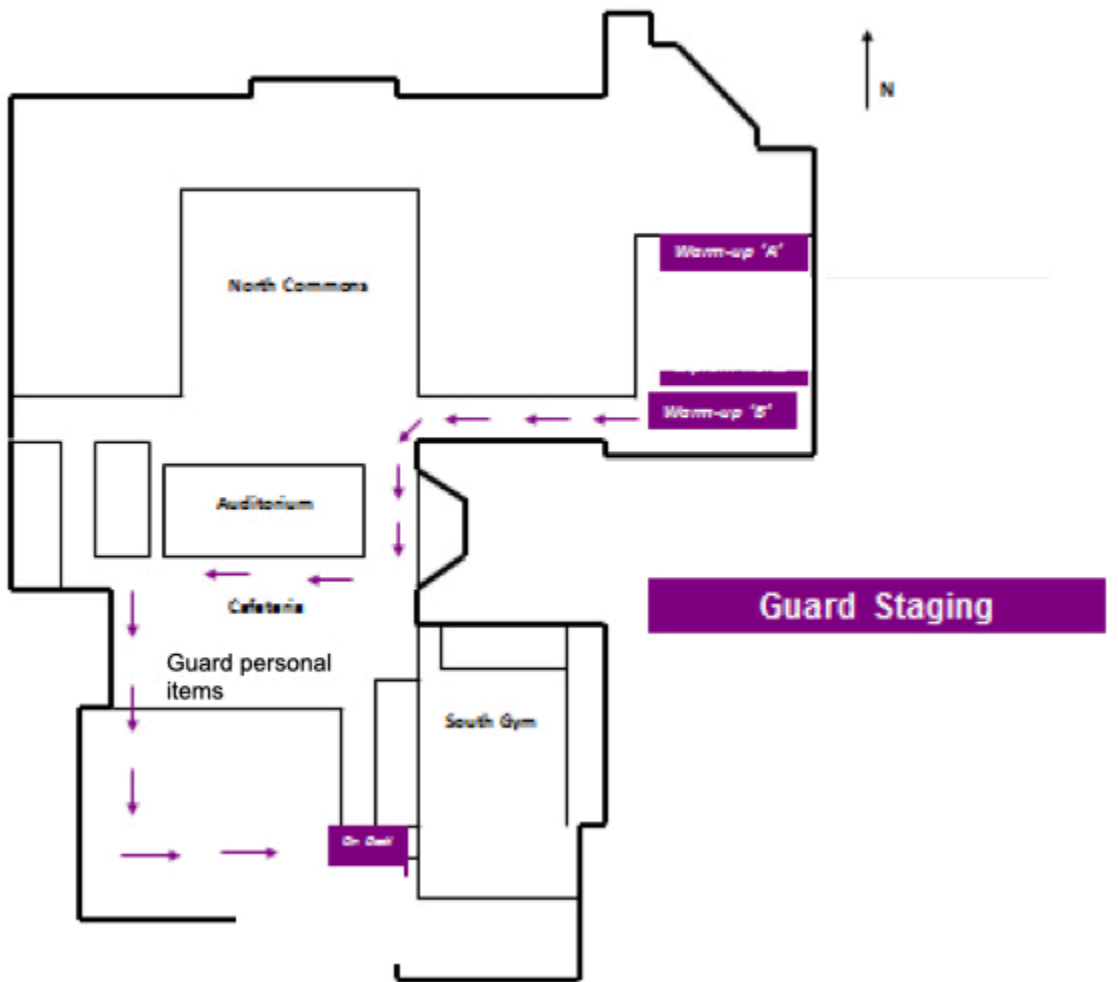

South Gym

