

Titan Winter Guard and Winter Percussion Competition February 1, 2020



Site Host Contact Information

Site Coordinators:

Diane Eich: diane.eich@cox.net, (402) 740-3039

Amy Fritch: stratygirl@gmail.com, (402) 301-6627

Joe Homan - Emergency only:
(402) 829-4602 – Office

HWAA President: Marques Eckhoff
president@hwaa.org

Papillion LaVista south
10799 Highway 370
Papillion NE 68046

DIRECTIONS TO PAVILLION LAVISTA SOUTH

Located on the south side of Highway 370 at 108th street.

MAPS

- Exterior and interior maps are included with this packet:
 - Aerial of school with address
 - Drawn school map, first floor
 - Drawn school map, second floor
 - Enlarge map of performance area

PARKING

- Bus parking: Front parking Lot (west side of school) to the north end
- Equipment Truck parking: Back parking lot (to east of stadium)
- Spectator parking: Front parking Lot (west side of school) to the south end; overflow may go to front stadium parking lot

UNIT CHECK-IN

- Check in will be in Fine Arts Hallway, west parking lot - north doors.
- At the check-in table, passes for participants and 7 staff/volunteer wrist bands will be provided. If you have late arriving staff members, leave their names with check-in staff at the time of check-in.
- If you have more than 7 staff/volunteers, admission will need to be purchased to enter the performance gym, even if they are assisting you with the performance.
- Each unit will receive one video pass to be used for your unit only.
- PLEASE REMIND YOUR PARENTS THAT VIDEO RECORDING FROM THE STANDS IS NOT ALLOWED

EQUIPMENT DROP OFF

- Equipment drop off will be in the east parking lot – north doors.
- Once items are dropped off, trucks will be parking on the east side of the STADIUM in the equipment truck parking area. This is not a check-in area. Students/parents unloading equipment will still need to go with their units to get show passes.
- All guard equipment is to be stored in the homeroom area.
- Guard props will be stored in hallways in designated areas.

HOMEROOMS/TEAM AREAS

- All belongings may be stored in the assigned homeroom/team areas.
- Homerooms will be a mix of classrooms, cafeteria, and commons. The upper level of the school will not be in use.
- Every area, except for the warm-up area, is a “No Spinning” and “No Playing” Zone.
- All costume changes will occur in the restrooms or in homerooms at each unit’s discretion.
- There are two sets of restrooms in the fine arts hallway by the cafeteria. There are also restrooms in the east hallway where props will be stored.

WARM-UP AREA

- Units have been assigned a Warm-up Area. Groups may use the time as they see fit. Warm-up times range from 14 to 20 minutes)
- Percussion Units are NOT permitted to march in warm-up.
- Warm-up area supervisors will alert units when there are five minutes and one-minute remaining.
- Units must leave on time to allow for transit to the on-deck area, as well as to allow the unit after them the full amount of warm-up time.

PERFORMANCE AREA

- This show will use a Vertical time line for percussion.
- This show will use a Vertical time line for guard.
- Units will wait to perform in the designated “on-deck” areas at the designated time.
- Units will enter the performance area from the south side doors farthest from the judges. They will exit the performance area using the north side doors farthest from the judges.
- Units will be allowed to re-fold their tarps in the gym during the break between the guard and percussion portions of the show only. No tarps can be re-folded after awards.
- Music checks are recommended for guards.
- Music checks must be done prior to the start of the show or during the class breaks.
- Host site can accommodate CDs and iPod/iPad/MP3 players. If using an iPod/iPad/MP3 player, please have a CD back up in case of difficulties.
- **There will be one extension cord at the front of the performance area with a power strip available. There are floor electrical outlets at the back of the performance area. All are centered.**

SPECTATOR ENTRANCE

- Spectators will enter the building from the west parking lot through the main middle doors.
- As set by HWAA Contest Rules admission prices are \$8 for adults and \$5 for students. Children under 5 years old are free.
- Location of spectator entrance – Spectators and staff will be sitting on the west side of the Titan Arena
- Location of participant watching entrance – Participants will be sitting on the east side of the Titan Arena. All participants must have a participant hand stamp to gain entrance to watch performances.
- All spectators must receive a spectator wristband to gain entrance to the performance area.

CONCESSIONS

- Concessions will be available at the concession stand in the hallway next to the show area.
- Concessions will open 30 minutes before the first performance and remain open until the final performance starts.
- Standard concession food will be offered.

SHOUT OUTS

- Shout outs will be available in the hallway next to the show area. They will be one dollar for a two line shout out.

MERCHANDISE

- The HWAA Merchandise Table will be in the hallway next to the show area

JUDGES CRITIQUE

- This is an adjudicated show. Judges’ critique will follow the end of the guard and percussion portions. Directors and staff are encouraged to take this opportunity to review the performance with the judges in location of critique.

ADDITIONAL INFORMATION

- In accordance with HWAA Membership and Contest Rules, Section VII.F
 - Section 1: Flash photography is strictly prohibited during the performance, as it is distracting to the performers and may cause injury. Photography without the use of flash permitted
 - Section 2: Individuals will be allowed to only record their own unit during season contest. Any person in violation of this will be asked to leave the premises or the device will be confiscated until the conclusion of the contest.
 - The video recording policy shall apply to all video recorders, camcorders, digital cameras, cell phones, iPads, tablets, and other devices with video and audio capability
- Each group will have a guide assigned to them when they register. A guide will stay with them until they are at the on-deck location.

Papillion La Vista south is located off Hwy 370, at 108th street
10799 Nebraska 370
Papillion, NE 68046

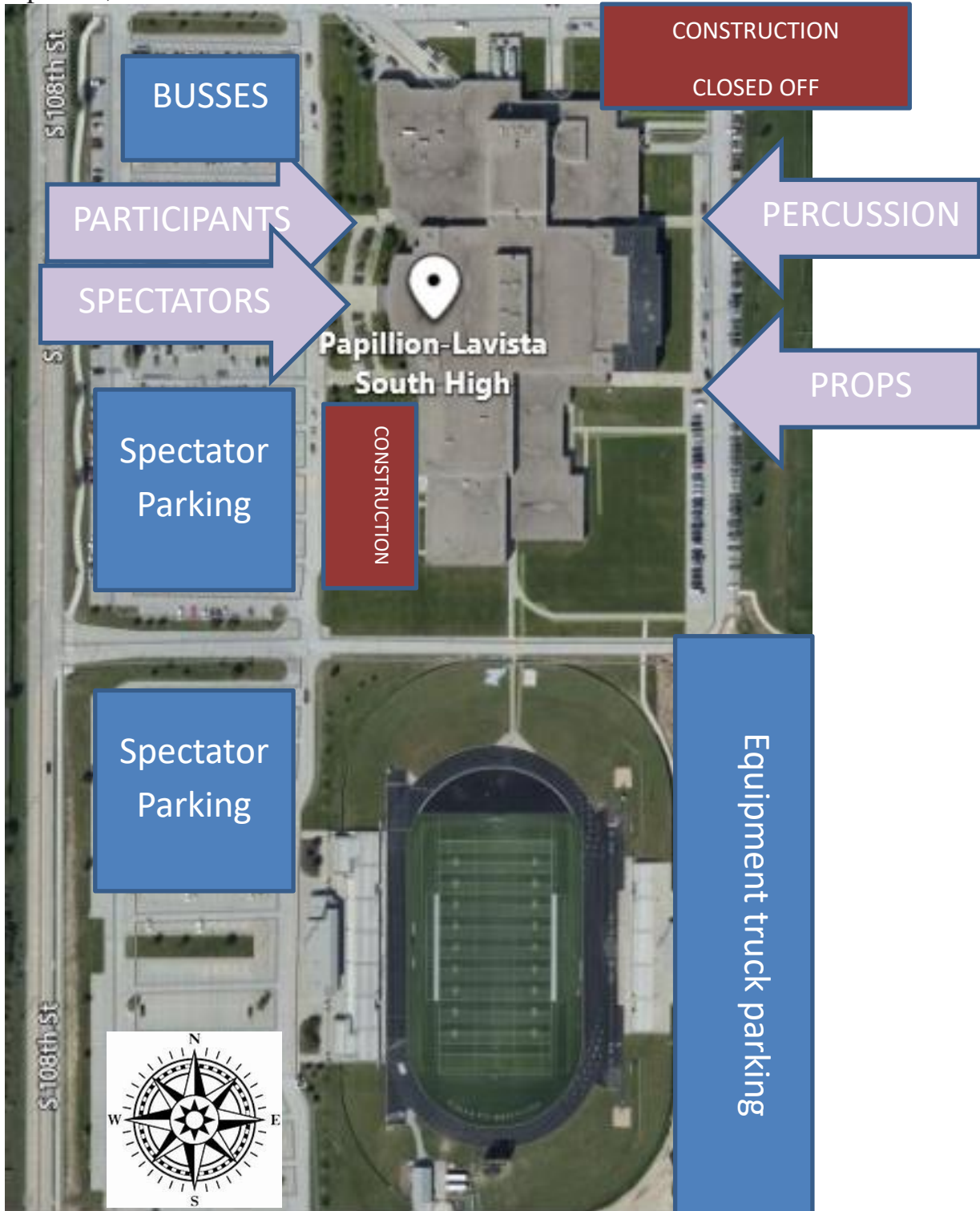

First Floor Interior Rooms
Travel Routes

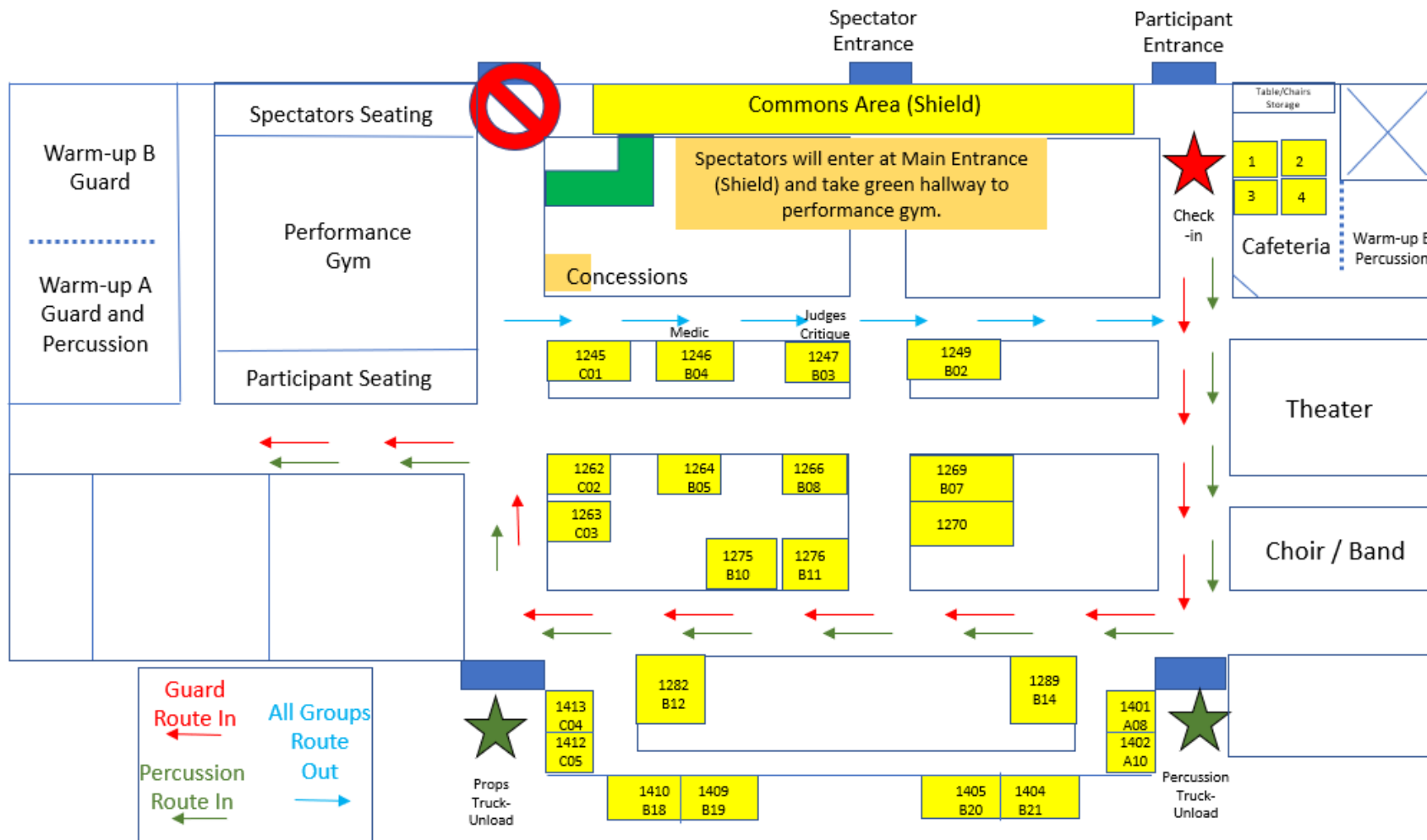

ENLARGED VIEW OF
PERFORMANCE SPACE

