

Columbus Indoor Contest

February 26, 2022



Site Host Contact Information

Site Coordinator: Jeff Peabody

Site Coordinator Contact Information Before Day of Contest:
peabodyj@discoverers.org – (308)216-1490

HWAA President: Jason Ross
president@hwaa.org

3434 Discoverer Drive
Columbus, NE 68601

DIRECTIONS

- Columbus High School is Located at 3434 Discoverer Drive in Columbus, Nebraska
- When arriving on Highway 30 from the East
 - Turn right (north) on East 6th Avenue and continue onto Lost Creek Parkway
 - At the Second Stop light turn left (south) onto 33rd Avenue
 - DO NOT turn into the parking lot by the football field, rather continue past the high school to Discoverer Drive (by the Digital Sign)
 - Turn right (west) onto Discoverer Drive
 - DO NOT turn into the first loop/pick up/drop off, rather take the second turn into the performers parking lot at the southwest part of the building

MAPS

- Exterior and interior maps are included with this packet
 - Arial map of the school with designated areas for performer parking, equipment drop off and entrances.
 - Floor plan for the first floor with designated areas for team spaces and equipment storage.
 - Enlarged map of performance area noting timeline, entrance and exit areas and power availability.

PARKING

- Bus/Performer Parking: Southwest parking lot, as accessed from the second turn off of Discoverer Drive. This lot will be designated for performer/bus parking only.
- Equipment Truck Parking: West Parking Pad. Following equipment dropoff at the unloading dock, Equipment Trucks will be directed to the parking pad on the west side of the building.
- Spectator Parking: Main Student Parking Lot. This lot is located on the south side of the building off of the first turn from Discoverer Drive.

UNIT CHECK-IN

- All Units should check in using the main (Central) Entrance to the high school.
- At the check-in table, passes for participants and 7 staff/volunteers will be provided. If you have late arriving staff members, leave their names with check-in staff at the time of check-in.
- If you have more than 7 staff/volunteers, admission will need to be purchased to enter the performance gym, even if they are assisting you with the performance.
- Each unit will receive one video pass to be used for your unit only.

EQUIPMENT DROP OFF

- Equipment Drop off will be at the unloading dock on the west side of the school.
- Once items are dropped off, trucks will be directed to the designated equipment truck parking area. This is not a check-in area. Students/parents unloading equipment will still need to go with their units to get show passes.
- All guard equipment is to be stored in the homeroom area.
- Prop/Tarp Storage will be on the north side of the Auxiliary Gym

HOMEROOMS

- All belongings may be stored in your designated Homeroom area within the cafeteria for guards and within the specified rooms for percussion.
- Guard units will be assigned to specific tables within the cafeteria for "homeroom" space. Percussion units will be assigned to a room where their equipment can be assembled and stored. Each space has double doors with removable bars to facilitate easy movement of equipment.
- Every area, except for the warm-up area, is a "No Spinning" and "No Playing" Zone.
- Locker rooms will be made available for costume changing.
- There will be three sets of restrooms open for public use.

WARM-UP AREA

- Units have been assigned a Warm-up Area. Groups may use the time as they see fit. (Warm-up times range from 14-20 minutes.)
- Warm-up area supervisors will alert units when there are five minutes and one minute remaining
- Units must leave on time to allow for transit to the on-deck area, as well as to allow the unit after them the full amount of warm-up time.

PERFORMANCE AREA

- o This show will use a Vertical time line for percussion
- o This show will use a Vertical time line for guard
- o Units will wait to perform in the designated "on-deck" areas at the designated time
- o Entrance from the warm-up area to the performance area is from the back side on the audience right, exit is on the front side to the audience left.
- o Units will be allowed to re-fold their tarps in the auxiliary gym following the guard portion of the event.
- o Music checks are recommended for guards
- o Music checks must be done prior to the start of the show or during the class breaks.
- o The site can accommodate iPhones, iPods, mp3 players, and CD's
- o Power will be available in the center front and center back areas of the performance space.

SPECTATOR ENTRANCE

- o Entrance is in the Center Main entrance to the school on the south side. There is no admittance through the Northeast doors.
- o As set by HWAA Contest Rules admission prices are \$8 for adults and \$5 for students. Children under 5 years old are free.
 - o Seating for spectators is on the east bleachers
 - o Participant seating (if needed) is on the north bleachers
- o All spectators must receive a spectator stamp/wristband to gain entrance to the performance area.

CONCESSIONS

- o The Concession Stand will be open from 12:30-the end of the contest.

SHOUT OUTS

- o Shout outs may be purchased at the table near the entrance to the gymnasium

MERCHANDISE

- o The HWAA Merchandise table will also be located near the entrance to the gymnasium

JUDGES CRITIQUE

- o This is an adjudicated show. Judges' critique will follow the end of the guard and percussion portions. Directors and staff are encouraged to take this opportunity to review the performance with the judges in Room C 113 (see map)

ADDITIONAL INFORMATION

- o In accordance with HWAA Membership and Contest Rules, Section VII.F
 - o Section 1: Flash photography is strictly prohibited during the performance, as it is distracting to the performers and may cause injury. Photography without the use of flash permitted
 - o Section 2: Individuals will be allowed to only record their own unit during season contest. Any person in violation of this will be asked to leave the premises or the device will be confiscated until the conclusion of the contest.
 - o The video recording policy shall apply to all video recorders, camcorders, digital cameras, cell phones, iPads, tablets, and other devices with video and audio capability
 - o Columbus Public Schools strongly recommends but does not require masks while inside the building.

← Lost Creek Expy →

← Lost

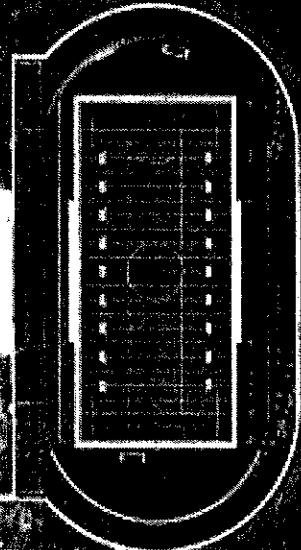

Officials/
Event Staff Parking

Equipment
Unloading

Entrance

Hdep Parking

Fan Parking

33rd AVE

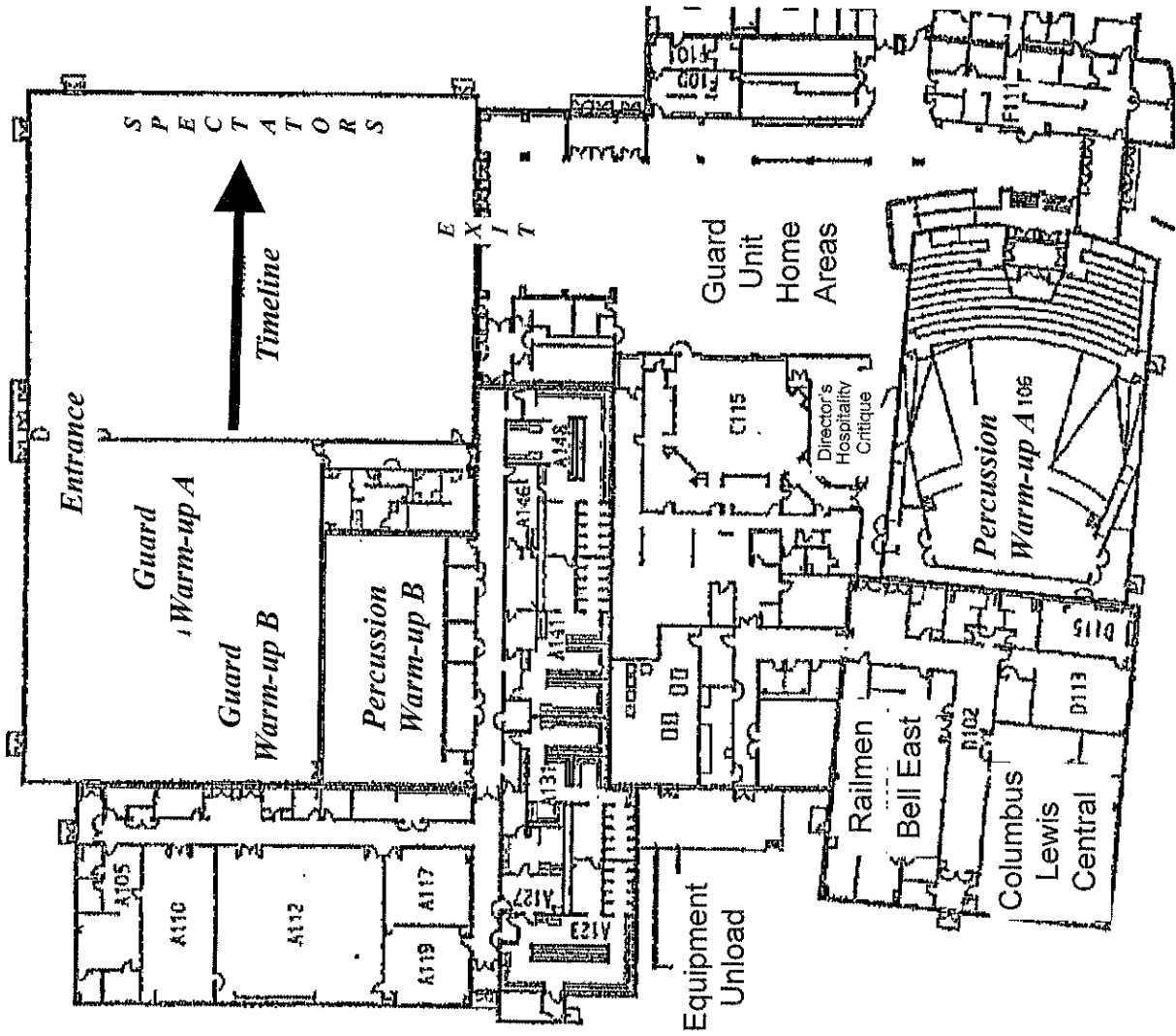

Performer and Spectator Entrance

SPECTATOR SEATING

SPECTATOR ENTRANCE

PERFORMANCE EXIT

POWER

POWER

VERTICAL TIMELINE

PERFORMANCE ENTRANCE

PERFORMER SEATING

NORTH

ANNOUNCER/MUSIC

