

# Columbus Indoor Contest

February 18, 2023



## Site Host Contact Information

Site Coordinator: Jeff Peabody

Site Coordinator Contact Information Before Day of Contest:  
[peabodyj@discoverers.org](mailto:peabodyj@discoverers.org) – (308)216-1490

HWAA Contest Director  
[contests@hwaa.org](mailto:contests@hwaa.org)

3434 Discoverer Drive  
Columbus, NE 68601

## DIRECTIONS

- Columbus High School is Located at 3434 Discoverer Drive in Columbus, Nebraska
- When arriving on Highway 30 from the East
  - Turn right (north) on East 6<sup>th</sup> Avenue and continue onto Lost Creek Parkway
  - At the Second Stop light turn left (south) onto 33<sup>rd</sup> Avenue
  - DO NOT turn into the parking lot by the football field, rather continue past the high school to Discoverer Drive (by the Digital Sign)
  - Turn right (west) onto Discoverer Drive
  - DO NOT turn into the first loop/pick up/drop off, rather take the second turn into the performers parking lot at the southwest part of the building

## MAPS

- Exterior and interior maps are included with this packet
  - Arial map of the school with designated areas for performer parking, equipment drop off and entrances.
  - Floor plan for the first floor with designated areas for team spaces and equipment storage.
  - Enlarged map of performance area noting timeline, entrance and exit areas and power availability.

## PARKING

- Bus/Performer Parking: Southwest parking lot, as accessed from the second turn off of Discoverer Drive. This lot will be designated for performer/bus parking only.
- Equipment Truck Parking: West Parking Pad. Following equipment dropoff at the unloading dock, Equipment Trucks will be directed to the parking pad on the west side of the building.
- Spectator Parking: Main Student Parking Lot. This lot is located on the south side of the building off of the first turn from Discoverer Drive.

## UNIT CHECK-IN

- All Units should check in using the main (Central) Entrance to the high school Located on the SOUTH side of the school
- At the check-in table, passes for participants and 7 staff/volunteers will be provided. If you have late arriving staff members, leave their names with check-in staff at the time of check-in.
- If you have more than 7 staff/volunteers, admission will need to be purchased to enter the performance gym, even if they are assisting you with the performance.
- Each unit will receive one video pass to be used for your unit only.

## EQUIPMENT DROP OFF

- Equipment Drop off will be at the unloading dock on the west side of the school.
- Once items are dropped off, trucks will be directed to the designated equipment truck parking area. This is not a check-in area. Students/parents unloading equipment will still need to go with their units to get show passes.
- All guard equipment is to be stored in the homeroom area.
- Prop/Tarp Storage will be on the north side of the Auxiliary Gym

## HOMEROOMS

- All belongings may be stored in your designated Homeroom area within the cafeteria for guards and within the specified rooms for percussion.
- Guard units will be assigned to specific tables within the cafeteria for "homeroom" space. Percussion units will be assigned to a room where their equipment can be assembled and stored. Each space has double doors with removable bars to facilitate easy movement of equipment.
- Every area, except for the warm-up area, is a "No Spinning" and "No Playing" Zone.
- Locker rooms will be made available for costume changing.
- There will be three sets of restrooms open for public use.

## WARM-UP AREA

- Units have been assigned a Warm-up Area. Groups may use the time as they see fit. (Warm-up times range from 14-20 minutes.)
- Warm-up area supervisors will alert units when there are five minutes and one minute remaining
- Units must leave on time to allow for transit to the on-deck area, as well as to allow the unit after them the full amount of warm-up time.

#### PERFORMANCE AREA

- o This show will use a Vertical time line for percussion
- o This show will use a Vertical time line for guard
- o Units will wait to perform in the designated "on-deck" areas at the designated time
- o Entrance from the warm-up area to the performance area is from the back side on the audience right, exit is on the front side to the audience left.
- o Units will be allowed to re-fold their tarps in the auxiliary gym following the guard portion of the event.
- o Music checks are recommended for guards
- o Music checks must be done prior to the start of the show or during the class breaks.
- o The site can accommodate iPhones, iPods, mp3 players, and CD's
- o Power will be available in the center front and center back areas of the performance space.

#### SPECTATOR ENTRANCE

- o Entrance is in the Center Main entrance to the school on the south side. There is no admittance through the Northeast doors.
- o As set by HWAA Contest Rules admission prices are \$8 for adults and \$5 for students. Children under 5 years old are free.
  - o Seating for spectators is on the east bleachers
  - o Participant seating (if needed) is on the north bleachers
- o All spectators must receive a spectator stamp/wristband to gain entrance to the performance area.

#### CONCESSIONS

- o The Concession Stand will be open from 12:00-the end of the contest.

#### SHOUT OUTS

- o Shout outs may be purchased at the table near the entrance to the gymnasium

#### JUDGES CRITIQUE

- o This is an adjudicated show. Judges' critique will follow the end of the guard and percussion portions. Directors and staff are encouraged to take this opportunity to review the performance with the judges in Room C 113 (see map)

#### ADDITIONAL INFORMATION

- o In accordance with HWAA Membership and Contest Rules, Section VII.F
  - o Section 1: Flash photography is strictly prohibited during the performance, as it is distracting to the performers and may cause injury. Photography without the use of flash permitted
  - o Section 2: Individuals will be allowed to only record their own unit during season contest. Any person in violation of this will be asked to leave the premises or the device will be confiscated until the conclusion of the contest.
  - o The video recording policy shall apply to all video recorders, camcorders, digital cameras, cell phones, iPads, tablets, and other devices with video and audio capability

Lost Creek Expy

Lost

Officials/  
Event Staff Parking

Equipment  
Unloading

Entrance

Hdcp Parking

Bus Parking

Fan Parking

33rd Ave

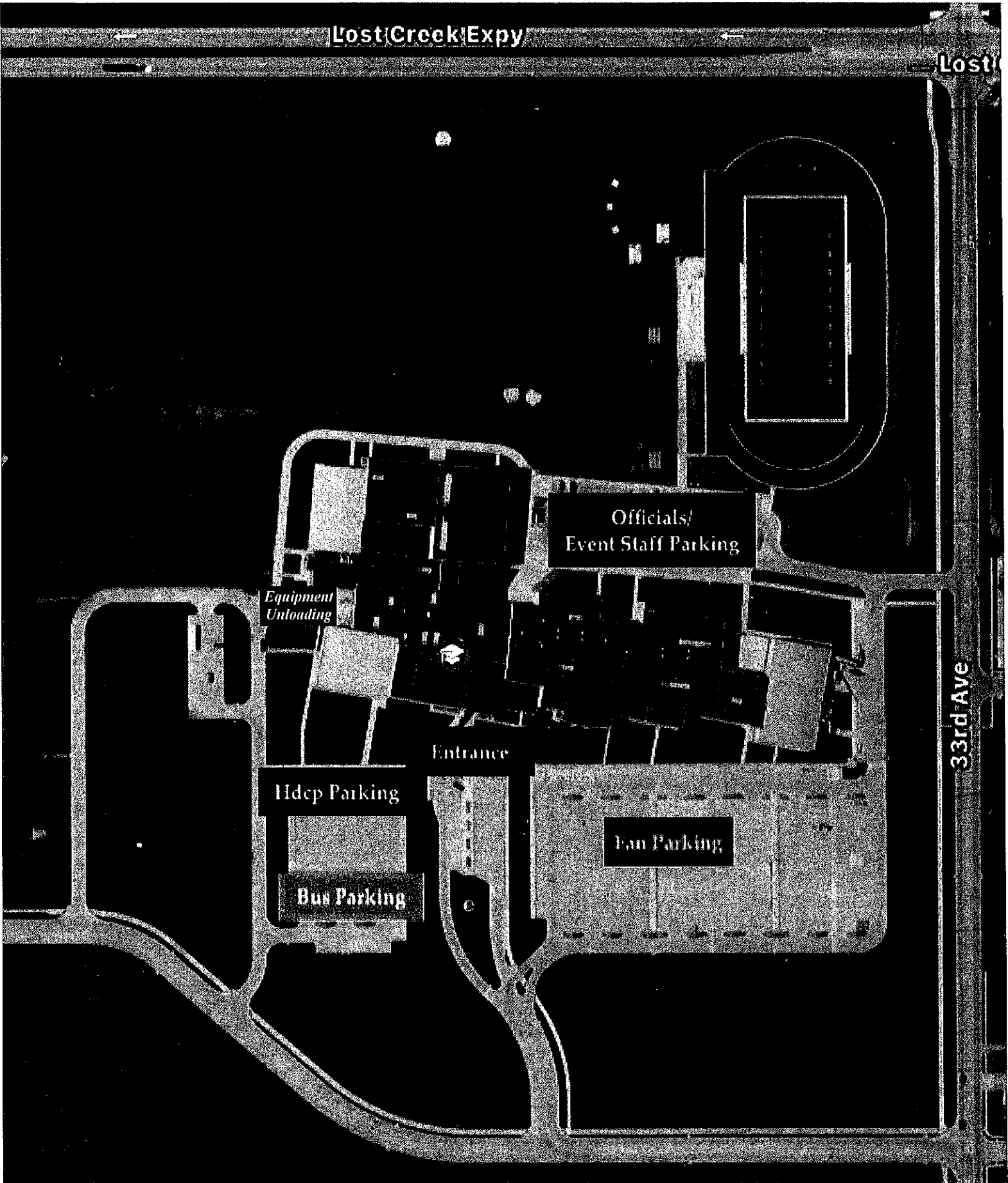

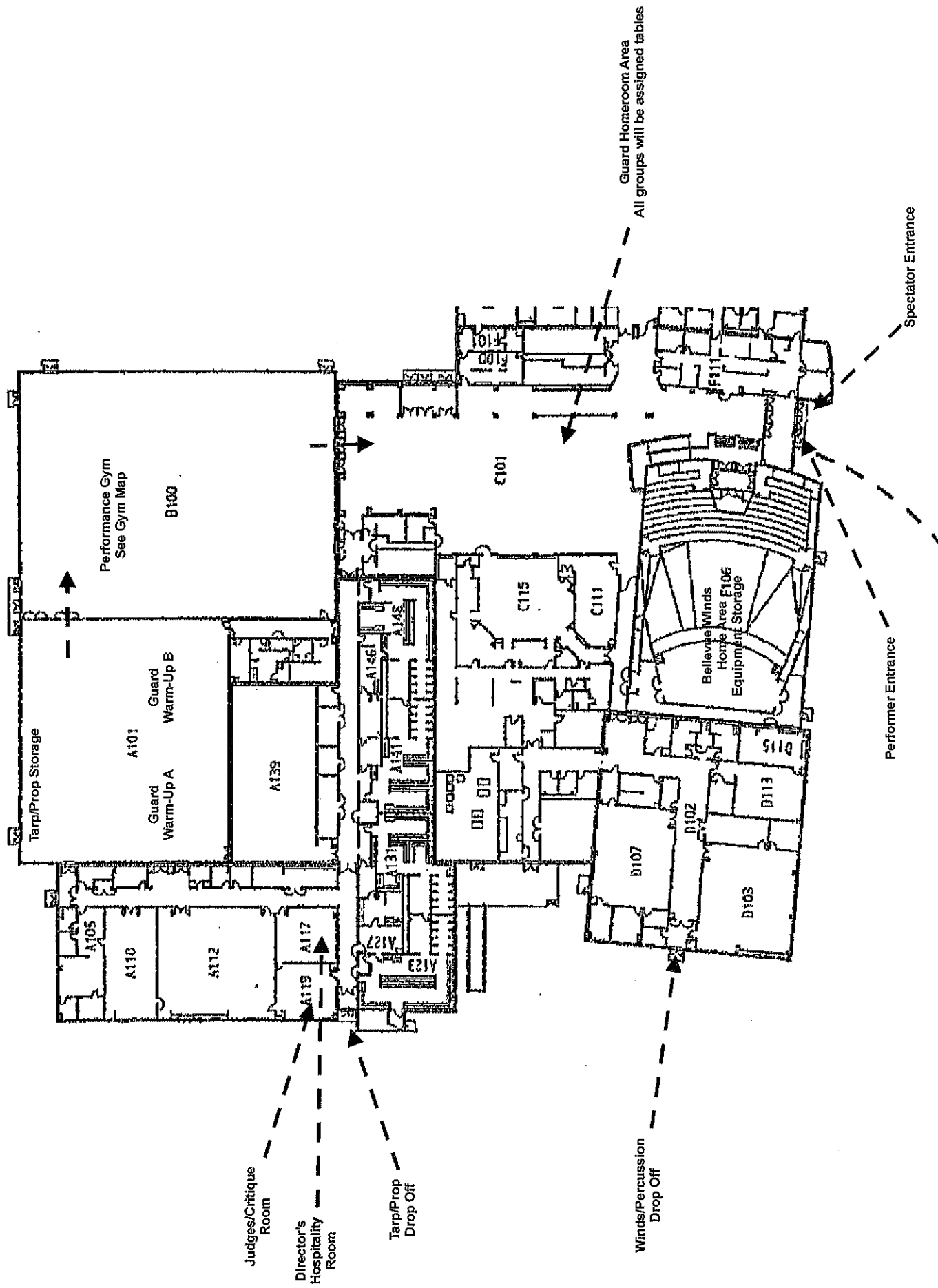

Tarp/Prop Storage

Performance Gym  
See Gym Map

B100

Guard Warm-Up A

A101

Guard Warm-Up B

A139

A105

A110

A112

A117

A119

A141

A142

A143

A144

A145

A146

A147

A148

A149

A150

A151

A152

A153

A154

A155

A156

A157

A158

A159

A160

A161

A162

A163

A164

A165

A166

A167

A168

A169

A170

A171

A172

A173

A174

A175

A176

A177

A178

A179

A180

A181

A182

A183

A184

A185

A186

A187

A188

A189

A190

A191

A192

A193

A194

A195

A196

A197

A198

A199

A200

C101

C111

C115

D103

D107

D113

D115

D119

D121

D122

D123

D124

D125

D126

D127

D128

D129

D130

D131

D132

D133

D134

D135

D136

D137

D138

D139

D140

D141

D142

D143

D144

D145

D146

D147

D148

D149

D150

D151

D152

D153

D154

D155

D156

D157

D158

D159

D160

D161

D162

D163

D164

D165

D166

D167

D168

D169

D170

D171

D172

D173

D174

D175

D176

D177

D178

D179

D180

D181

D182

D183

D184

D185

D186

D187

D188

D189

D190

D191

D192

D193

D194

D195

D196

D197

D198

D199

D200

E101

E102

E103

E104

E105

E106

E107

E108

E109

E110

E111

E112

E113

E114

E115

E116

E117

E118

E119

E120

E121

E122

E123

E124

E125

E126

E127

E128

E129

E130

E131

E132

E133

E134

E135

E136

E137

E138

E139

E140

E141

E142

E143

E144

E145

E146

E147

E148

E149

E150

E151

E152

E153

E154

E155

E156

E157

E158

E159

E160

E161

E162

E163

E164

E165

E166

E167

E168

E169

E170

E171

E172

E173

E174

E175

E176

E177

E178

E179

E180

E181

E182

E183

E184

E185

E186

E187

E188

E189

E190

E191

E192

E193

E194

E195

E196

E197

E198

E199

E200

F101

F102

F103

F104

F105

F106

F107

F108

F109

F110

F111

F112

F113

F114

F115

F116

F117

F118

F119

F120

F121

F122

F123

F124

F125

F126

F127

F128

F129

F130

F131

F132

F133

F134

F135

F136

F137

F138

F139

F140

F141

F142

F143

F144

F145

F146

F147

F148

F149

F150

F151

F152

F153

F154

F155

F156

F157

F158

F159

F160

F161

F162

F163

F164

F165

F166

F167

F168

F169

F170

F171

F172

F173

F174

F175

F176

F177

F178

F179

F180

F181

F182

F183

F184

F185

F186

F187

F188

F189

F190

F191

F192

F193

F194

F195

F196

F197

F198

F199

F200

Judges/Critique Room

Director's Hospitality Room

Tarp/Prop Drop Off

Winds/Percussion Drop Off

Guard Homeroom Area  
All groups will be assigned tables

Performer Entrance

Spectator Entrance

Bellevue Winds Home Area  
Equipment Storage

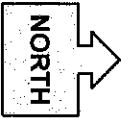

**PERFORMER SEATING**

**PERFORMANCE ENTRANCE**

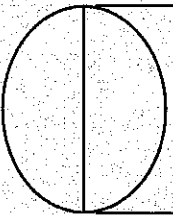

**VERTICAL TIMELINE**

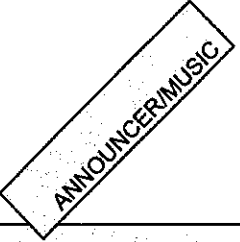
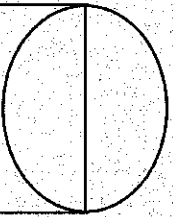
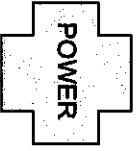
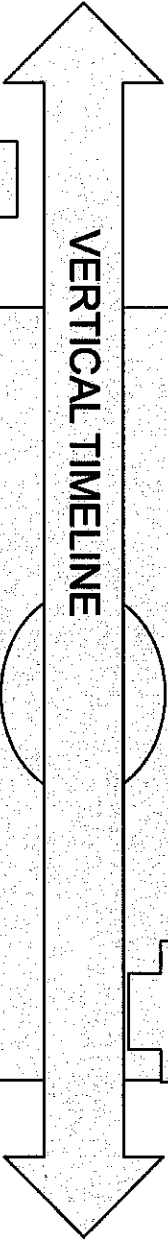

**SPECTATOR SEATING**

Here's the **SCOOP**

**COLUMBUS HIGH SCHOOL BAND BOOSTERS**

# **FUNDRAISER**

## *Sundae Fundae*



.....  
**SATURDAY, FEBRUARY 18**

**In conjunction with the  
HWAA Competition**

**CHS CAFETERIA**  
.....

**\$5 Single Cup (double scoop)**

**A Variety of Toppings Available!**

**\$4 Rootbeer Float**

# Food/Snacks

Hot dogs.....	\$3.00
Hamburgers.....	\$4.00
Cheeseburgers.....	\$5.00
Dominos Pizza (after 4 PM).....	\$3.00
Nachos .....	\$3.00
Pretzel w/ nacho cheese .....	\$3.00
Chips.....	\$1.00
Popcorn.....	\$1.00
Pickle .....	\$1.00

Candy.....	\$2.00
Kit Kat, Hershey's, Reese's PB Cups, Twix, M&M's, Peanut M&M's, Skittles	
Ring Pops.....	\$1.00
Air Heads .....	3 for \$1.00

# Ice Cream

Ice Cream Sundae .....	\$5.00
Root Beer Float.....	\$4.00

# Drinks

All Drinks .....	\$3.00
Coke, Diet Coke, Cherry Coke, Sprite, Pibb Xtra, Blue Powerade, Red Powerade Dasani Water	

